



FIRESTOP CENTRE

Authorised New Zealand Distributor
Ph (09) 483 4000 www.firestopcentre.co.nz

Allproof Drop-In Fire Collar Cables or Pair Coils through a 2x13mm Plasterboard Ceiling-Floor

INSTALLATION INSTRUCTIONS:

1. Ensure substrate around services is flat and free from obstructions.
2. Seal the annular space between the plasterboard and the services with Allproof MAS310 fire sealant to a depth of at least 13mm.
3. Open the fire collar and position around the services.
4. Slide the tab through the slot in the collar and fold back 180o to secure.
5. Secure the collar using metal hollow wall anchors fixed directly into the plasterboard. Do not use fixings which rely on plastic or nylon components for grip.
6. Finally seal the space between the services and the particleboard with a silicone sealant.

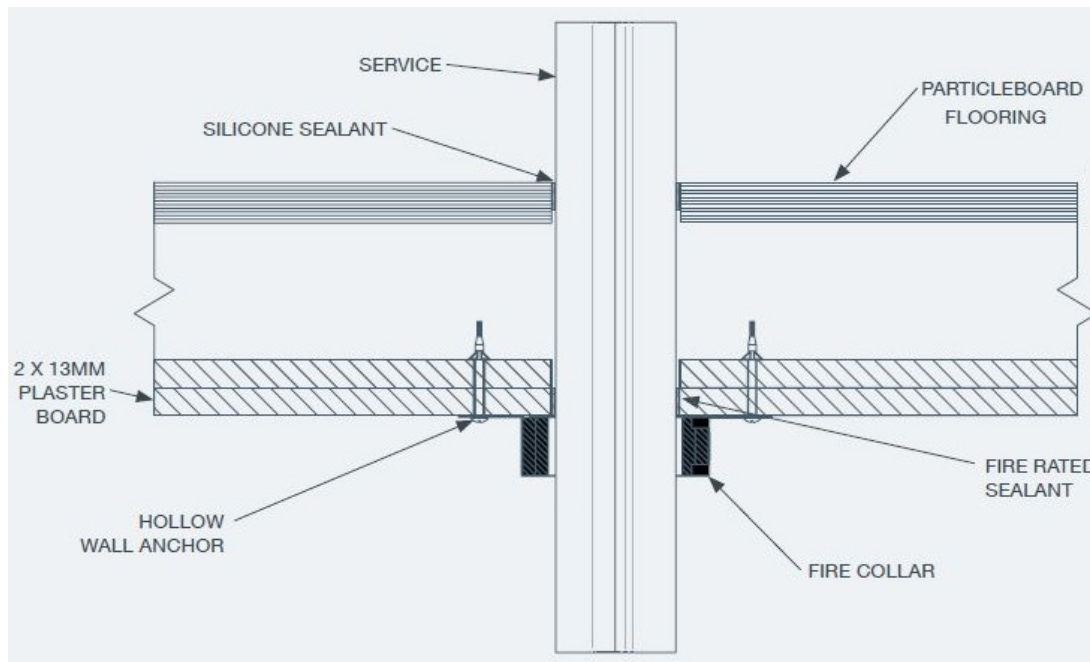

BRANZ Appraised
Appraisal No.1088 [2019]

As a part of our policy of on-going product development and testing, we reserve the right to modify, alter or change product specifications without giving notice. All information contained in this document is given in good faith and is provided for guidance only. Any drawings provided are for illustrative purposes only. As Firestop Centre has no control over the methods or competence of installation and of prevailing site conditions, no warranties, expressed or implied, is intended to be given as to the actual performance of the product mentioned or referred to herein and no liability whatsoever will be accepted for any loss, damage or injury arising from the use of the information given.

For all technical details on the products specified please refer to the technical data sheets that can be found on www.firestopcentre.co.nz

Signed and approved:



BRANZ Appraisal 1008
Technical Manual - Electrical Pg 7
AS1530.4-2014 AS4072.1-2005

System ID# FC631

Products	Allproof Low-Profile Fire Collar
Application	Fire stopping of cables and pair coils in floor-ceiling system
Construction	Ceiling of 2x13mm fireboard and floor above of 19mm particleboard with frame 190mm or greater

Fire Classification:

See **Page 2** for details of the following:-

Cables - TPS, CAT6 Data, Fire Alarm, Fibre Optic, Mains and Earth cables in various combinations
Up to FRR -/90/90

Air-con mixed services - Up to 3 x pair coils, 3 x TPS cables and 1 x 25mm PVC DWV conduit
Up to FRR -/90/90

ALLPROOF

INDUSTRIES

Allproof Industries Ltd
17 Bay Park Place
Beach Haven, AK 0626

Sheet size: A4	Drawn date & no: 28/5/25
Scale: NTS	Drawn by: G.P

2 X 13MM PLASTERBOARD CEILING TEST RESULTS:

DESCRIPTION	PRODUCT CODE	PENETRATION HOLE SIZE (MM)	PLASTERBOARD FRL*	REPORT NUMBER
CABLES				
1x TPS Cable	ALLFC25	28	-/90/90	146206
7x TPS Cables	ALLFC25	32	-/90/90	142100
8x TPS Cable	ALLFC50	32	-/90/90	146206
1x CAT6 Data Cable	ALLFC25	28	-/90/90	146206
10x CAT6 Data Cables	ALLFC25	28	-/90/90	142100
11x CAT6 Data Cable	ALLFC50	28	-/90/90	146206
1x Fire Alarm & 1x Fibre Optic Cable	ALLFC40	32	-/90/90	146206
10x Fire Alarm & 10x Fibre Optic Cables	ALLFC40	32	-/90/90	146206
1x 16mm Mains Cable + 1x 10mm Earth Cable	ALLFC25	28	-/90/90	146206
1x 25mm Mains Cable & 1x 10mm Earth Cable	ALLFC25	28	-/90/90	142100
A/C MIXED SERVICES				
Pair Coil, TPS Cable & 10mm PVC Pipe	ALLFC50	60	-/90/90	142100
3x Fire Rated Pair Coil, 3x TPS Cables & 1x 25mm PVC DWV	ALLFC100	102	-/90/60	146206

Fixing: Collars tested using hollow wall anchors.

For installations resulting in an annular gap of 4mm or greater insert PE backing rod prior to fire rated sealant and/or silicone sealant.

Tested using a 190mm deep timber framing with two layers of 13mm fire rated plasterboard on the exposed side of the frame and 19mm particleboard flooring on the unexposed side of the frame. A total floor-ceiling thickness of 235mm. Pipe collars are fixed using hollow wall anchors directly into the plasterboard - not fixed into framing or studs. Fire rated sealant is applied in the space between the services and plasterboard on the exposed face and silicone sealant between the service and particleboard flooring on the unexposed face.

2X 13MM PLASTERBOARD CEILING INSTALLATION DETAILS:

